

# PYROSTRIP 210

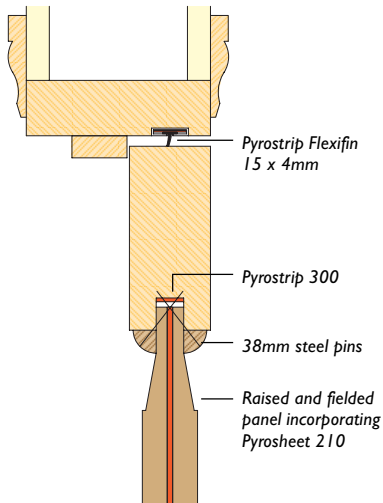

30 minute panel cross-section through rails

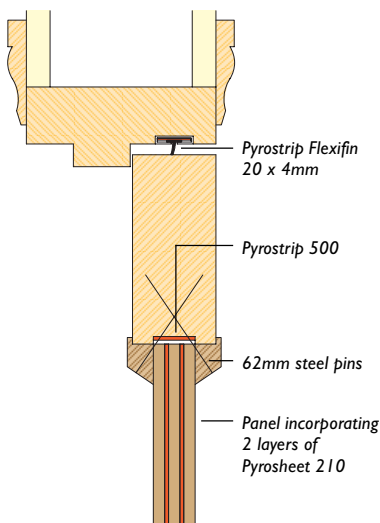

60 minute panel cross-section through rails

Pyrostrip 210 enables traditional panelled doors to provide 30 and 60 minute fire resistance. Mann McGowan Pyrostrip 210 intumescent sheets are sandwiched between hardwood, plywood or MDF to provide composite panels suitable for door manufacture and upgrading of existing doors.

Pyrostrip 210 is equally suitable for upgrading existing or manufacturing new fire resisting doors. It is rigid and easily cut and is thus much faster and cleaner to work than soft fibrous materials.

Pyrostrip 210 is based on an intumescent core of hydrated sodium silicate which expands when heated.

Composite sheets are chamfered at the edges and rebated into stiles, muntins and rails. The depth of the rebate should allow for movement of the panel but the gap may present a weakness in a fire. This is dealt with by incorporating the appropriate Mann McGowan intumescent fire seal in the base of the groove. For 30 minute resistance Pyrostrip 300 10mm x 2mm is required and for 60 minute resistance Pyrostrip 500 20mm x 2mm.

The interaction of the components of panelled doors is critical to the doors' performance. Specifiers and users should ensure good quality workmanship.

Fire test reference	Standard	Resistance
Chiltern Int Fire IF 97036a	BS 476 Part 22	30 minutes
Chiltern Int Fire FEA 9806 I	BS 476 Part 22	30 minutes
Chiltern Int Fire IF 97036b	BS 476 Part 22	53 minutes
Chiltern Int Fire IF FEA	BS 476 Part 22	60 minutes
SGS FT/10386.1/RP/93	BS 476 Part 22	56 minutes
TRADA/LWF	BS 476 Part 22	34 minutes
Mann McGowan 30.1 66a	DIN 4102 Section 2	51 minutes
Warrington/English Heritage 48926	BS 476 Part 22	28 minutes

*Pyrostrip 210 intumescent sheet has been tested and assessed to BS 476, Part 22 as well as to DIN 4102. Pyrostrip 210 panels have also been successfully tested by a number of door manufacturers.*



Member Glass and Glazing Federation



Certificate No: 93/2172



BRITISH WOODWORKING FEDERATION



FIRAS MEMBER

For comprehensive technical advice and assistance on intumescent fire protection contact Mann McGowan's Technical Department. Mann McGowan is registered to ISO 9002. Orders can be placed direct to our sales office:

**Mann McGowan Fabrications Ltd**  
**Intumescent House**  
**9 Springlakes Estate, Deadbrook Lane**  
**Aldershot, Hampshire, GU12 4UH**  
**United Kingdom**

Telephone **01252 333601** International +44 1252 333601  
 Facsimile **01252 322724** International +44 1252 322724

**Substitution of the intumescent specification will invalidate construction details indicated.**

Pyrostrip is a registered trademark of Mann McGowan Fabrications Ltd. The contents of this document are copyright throughout the world and, other than specification clauses, may not be reproduced in any form without the prior written permission of Mann McGowan Fabrications Ltd. Information in this document is provided for guidance and does not form part of any contract.

Photograph of fire resistant panelled door supplied by Drayton Joinery Ltd

*Mann McGowan Fire Door Components*

# PYROSTRIP 210

## **PYROSTRIP 210**

### *Intumescent fire resistant door panels*

Pyrostrip 210 enables traditional panelled doors to provide 30 and 60 minute fire resistance. Mann McGowan Pyrostrip intumescent sheets are sandwiched between hardwood, plywood or MDF to provide composite panels suitable for door manufacture and upgrading of existing doors.

