



FR Water Based Silicone

Sealing of Linear Expansion / Construction Joints and Service Penetrations

Technical Data Sheet

Product Description

Abesco Fire Rated Water-Based Silicone is a one component low-modulus sealant designed to prevent the spread of fire and smoke from one compartment to another through joints and gaps in fire separating walls and floors. It has excellent adhesion and when cured forms a flexible, strong silicone seal. Abesco FR WB Silicone can be used to seal gaps up to 80mm width. It is ideal for internal and external expansion and construction joints, curtain walling and joints subject to vibration and movement. FR WB Silicone has a fungicide addition so it can be used in sanitary and plumbing applications. It is paintable* with most household paints and odourless, can be used on humid surfaces (curing times may increase when the surface is damp or wet) and requires only water to clean down tooling and overfill.

Where there is an insulation requirement it is advised to use a mineral fibre backing material or alumina silicate capped at both faces of the joint.

* Depending on paint type. Abesco Ltd strongly recommend a trial is undertaken on an unseen area before major painting is undertaken.

Fire Performance Table

Construction	Insulation	Integrity
Linear Gaps up to 50mm	240 mins	240 mins
Linear Gaps up to 80mm	120 mins	120 mins
Service Penetrations	Up to 240 mins depending on type*	240 mins

* Contact Abesco for details

Fire Test Standards

Tested in accordance with the methodology and criteria described in:-

- BS EN 1366-3: 2004
- BS 476 Part 20, BS EN 1363-1
- AS 1530 Part 4
- prEN 1366-4: 2005

As part of our policy of ongoing improvement, we reserve the right to modify, alter or change product specifications without giving notice. Product illustrations are representations only. All information contained in this document is provided for guidance only, and as Abesco Limited has no control over the installation methods of the products, or of the prevailing site conditions, no warranties expressed or implied are intended to be given as to the actual performance of the products mentioned or referred to, and no liability whatsoever will be accepted for any loss, damage or injury arising from the use of the information given of products mentioned or referred to herein.

Abesco Ltd, Abesco House
Laurencekirk Business Park
Laurencekirk
Scotland, UK
AB30 1EY

Phone: +44 (0) 1561 377766
Fax: +44 (0) 1561 378887
Email: technical@abesco.co.uk
Website: http://www.abesco.co.uk

Typical Detail for Linear Joints

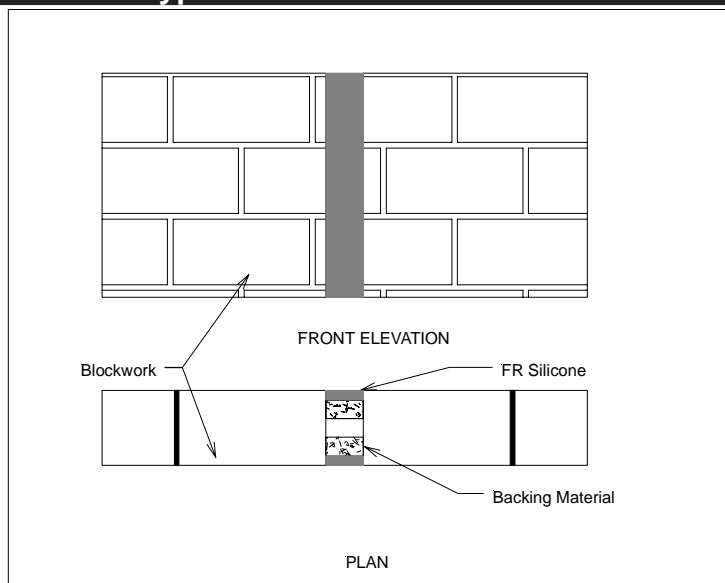

Installation Instructions

- 1 The joint surfaces must be clean and preferably dry (wet surfaces may extend the curing time). Remove any debris and dust and ensure non-porous surfaces are degreased.
- 2 Where a neat finish is required mask the edges of the joint.
- 3 Expansion joints must use a suitable backing material to regulate the depth of seal. For joints up to 12mm wide the width to depth ratio should be 1:1. Larger joints should have a width to depth ratio of 2.5:1 (depth no less than 12mm).
- 4 When sealing service penetrations, ensure that services are independently and suitably supported. A backing material of either mineral wool or urethane rods should be installed into the annular space in accordance with the tested configuration.
- 5 Extrude sealant firmly into the joint to the correct depth avoiding trapping air. Smooth sealant with a water-wet spatula.
- 6 Wood surfaces are generally porous, therefore it is recommended that such surfaces are moistened to improve adhesion. In such cases, remember that curing times may increase.
- 7 Remove any masking tape whilst sealant is soft.
- 8 Excess uncured sealant can be removed with a clean damp cloth.

Technical Data

S.g.	1.35
Tack Free Time	25 mins approx
Application Temp	+2C to +40C
Service Temp	-50C to +120C
Shore A Hardness	20
Elastic Recovery	>80%
Joint Movement	25%
Modulus at 100%	0.37MPa